

EVEN CUT

HOME HAIRCUTTING KIT • 10 PIECES



Instruction Booklet

For your safety and continued enjoyment of this product, always read the instruction booklet carefully before using.

CONAIRMAN
Respect the Ritual®

HC900 Models

READ THESE SAFETY PRECAUTIONS CAREFULLY BEFORE USING THE UNIT!

SAFETY PRECAUTIONS

WARNING: the polyethylene bags over the product or its packaging may be dangerous. Keep these bags out of the reach of babies and children. Never use them in cribs, children's beds, pushchairs or playpens. The thin film may cling to the nose and mouth and prevent breathing. A bag is not a toy.



WARNING: do not use over or near washbasins, bathtubs, showers or other containers with water. Store the unit in a dry place.

1. If you are using the unit in a bathroom, unplug it after you have finished using it. Using the unit close to a source of water can, in fact, be dangerous, even if the unit is switched off. To ensure additional protection, have installed in your bathroom a residual current device (RCD) with a nominal trip current no higher than 30 mA. Ask your electrical fitter for advice.
2. Never immerse the unit in water or any other liquid.
3. Do not use the unit if it has fallen or if it appears to be damaged.
4. Do not leave the unit unattended when it is plugged in or switched on.

5. Unplug the unit immediately if you have problems when using it.
6. Do not use any accessories other than those recommended by Conair.
7. Unplug the unit after each use and before cleaning it.
8. Avoid any contact between the unit's hot surfaces and your skin, in particular, your ears, eyes, face and neck.
9. Allow the unit to cool before storing.
10. To prevent damage to the cord, do not wrap it around the unit and ensure it is stored without twisting or folding it.
11. To reduce hazards, damaged power cords must be replaced by the manufacturer or an authorized service center.
12. This appliance is not a toy. Keep away from children.
13. **WARNING:** This appliance is not designed for persons (including children) with reduced physical, sensory or mental capabilities, or lack of experience and knowledge, unless they are under the supervision or instruction on the use of the appliance by a person responsible for their safety.

SAVE THESE INSTRUCTIONS

USER MANUAL

The Conairman Even Cut® Clipper is a revolution in home haircutting. The clipper's unique circular blades mean that it can be used in any direction over the head to maintain an all over-even cut.

The clipper comes with adapter:
Adapter: CA15
Rating input: 100-240V~ 50-60Hz
Rating output: 3.0V--- 1.5A 4.5W

CAUTION

1. Dry location use only. Do not expose to liquids, vapor, or rain.
2. Do not operate any appliance that has a damaged output cord or housing.
3. Always unplug the unit before cleaning or when not in use.
4. This power unit is intended to be correctly oriented in a vertical or floor-mount position.
5. Be sure voltage is correct before plugging in.

FEATURES

- Corded or cordless operational clipper. Use corded for continuous power while plugged into the outlet or use cordless for total flexibility and control during use.
- Ultra-sharp stainless steel blades for fast, precise cutting.
- Ergonomic design – it fits into the palm of your hand.
- 2 adjustable comb guides for grades 1–4 (comb guide 1 cuts lengths 1/8", 1/4" and 3/8," and comb guide 2 cuts length 1/2").
- Includes barber comb, neck brush, scissors, storage pouch, oil, and barber cape.

The hair clipper is perfect for maintaining a short, even length all over. It has been designed with a unique rotary cutting system and circular comb guides to give a guaranteed, even finish. Because of this revolutionary technology, the cutting technique differs somewhat from that of a normal clipper, in fact, this cutting technique is much simpler!

The Even Cut® is designed for cutting grades 1–4 to an even length. **It is not, however, suitable for layering or grading.** A shorter hairstyle length (1" or less is recommended), is needed for initial use of this item. There are two comb guides; the smaller comb guide is for grades 1–3 and the larger comb guide for grade 4. Note Comb Guides section for detailed breakdown of lengths.

First, select the desired comb guide and lock the length setting in place, lining up the grade length number to the grade setting indicator line.



For the best results, we advise you start cutting the back of the head. With a sweeping motion, run from the back to the front of your head, concentrating on one area until you reach the desired length.

Once you have completed this over your whole head, you should then finish, using circular motions as this ensures you achieve a perfect, even finish. Please note that when you first begin cutting your hair you may notice that some hair is being cut and other hairs are left long. This is perfectly normal, especially if you are cutting longer hair. This is because hair grows in different directions and the Even Cut® clipper is designed to be used in all directions against the hair growth. So continue cutting in all directions until all hair is cut to length, then the use of circular motions over the whole head will ensure an even finish.

OPERATION

CHARGING INSTRUCTIONS

IMPORTANT — The Even Cut® is so easy to use, but before you do anything you must take your time to charge the unit for 16 hours before its first use. Even if you want to use it plugged in straight from the outlet, this initial super-charge ensures optimum power performance to give smooth, fast cutting every time. Only use the adapter supplied with this appliance. Using other adapters may cause a hazard.

- Before using for the first time, the appliance should be fully charged continuously for 16 hours. Maximum battery capacity will only be reached after 3 charging and discharging cycles.
- Ensure the appliance is switched OFF.
- Insert the small plug on the charging adapter into the socket on the side of the appliance.

- Plug the charging unit into a suitable outlet socket.
- The red charging indicator light on the power handle will illuminate when the appliance is correctly connected to the outlet.
- A full charge will supply enough power for approximately 20 minutes of use.

OILING INSTRUCTIONS

IMPORTANT — It is highly recommended before each use to oil the circular blades with the oil provided. This ensures optimum cutting performance.

For the first use, you will need to use the oil supplied with the product. Unscrew the cap and cut off the very end of the plastic tube with a pair of scissors to release the oil.

PRESERVING THE BATTERIES

In order to maintain the optimum capacity of the rechargeable batteries, the appliance has to be fully discharged and then recharged for 16 hours approximately every 6 months.

COMB GUIDES

The appliance is supplied with 2 adjustable comb guides that provide 4 cutting lengths from grades 1–4.

The comb guide with the shorter teeth will cut at the 3 shorter lengths, while the comb guide with the longer teeth will cut at the 1 longer length setting.

If you desire a grade 0 cut, the clipper can be used without a comb guide for an ultra-close, even cut.

| CUTTING LENGTH | GRADE |
|----------------|-------|
| 1/8" | #1 |
| 1/4" | #2 |
| 3/8" | #3 |
| 1/2" | #4 |

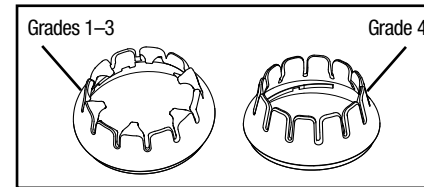

ATTACHING A COMB GUIDE

To attach a comb guide, make sure the appliance is switched OFF. Hold the clipper with the blades facing downward and place the comb guide over the top of the clipper with the teeth of the comb facing downward. Release the comb guide locking mechanism, located on the side of the appliance, by sliding it away from the comb guide. Line up the dot indicator on the comb guide (Fig. 1) with the grade setting marker on the clipper (Fig. 1), then gently rotate the comb guide in a counterclockwise direction until it clicks into place (Fig. 2). Make sure that the locking mechanism is in the locked position and the comb guide is securely in place before using the clipper.

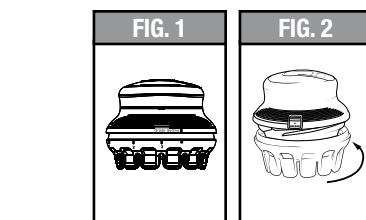

CHANGING THE COMB GUIDE LENGTH SETTING

Comb guide 1 for grades 1–3 will lock into 3 different positions, providing 3 cutting length grade settings. Comb guide 2 for grade 4 locks into 1 position and provides 1 cutting length grade setting. The comb guide will be marked with its grade settings (Fig. 3). In order to change the grade setting, release the comb guide locking mechanism found on the side of the clipper (Fig. 4), and rotate the comb guide either clockwise or counterclockwise as appropriate (Fig. 5). Line up the grade setting you want with the "1" mark on the clipper. Make sure that the locking mechanism is in the locked position and the comb guide is securely in place before using the clipper.

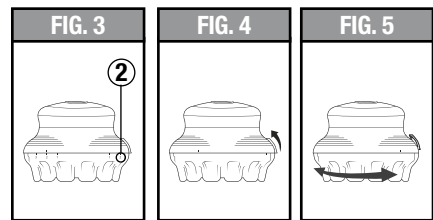

REMOVING A COMB GUIDE

To remove the comb guide, unclip the guide locking mechanism found on the side of the clipper and rotate the comb guide in a clockwise direction until it is completely free of the clipper.

PREPARATION FOR USE

- Always inspect the appliance for noticeable signs of damage. Do not use if damaged.
 - Always inspect the appliance before use to ensure the clipper blades are free from hair, debris, etc. (See Cleaning & Maintenance of Clipper.)
 - Prior to use, always inspect the head for warts, moles, spots and broken skin. If using the clipper on yourself, either use mirrors or ask another person to check for you. Special care should be taken when cutting hair in areas that have warts, moles, spots or broken skin, to prevent injury.
 - Remove any head jewelry such as earrings and necklaces before use.
 - For best performance, use on clean, dry hair that has been combed until tangle free.
 - If hair is long, use the scissors and comb provided to cut the hair prior to using the clipper.
 - Ensure the appliance is sufficiently charged or plugged into the outlet.
- NOTE:** The appliance should not be used for longer than 15 minutes when operated from the outlet.

WARNING — The clipper is for use only on the head. Never use the clipper on the face or any other area of the body.

IMPORTANT — Do not attempt to trim hair close to your ears with the clipper. Never allow ears to enter the ring of the clipper blade.

CLIPPING

- Attach a comb guide as required. Note Comb Guides section for specific lengths.
- Switch ON the clipper using the ON/OFF sliding switch located on top of the clipper, and the blades will start to move and the green LED will illuminate.
- Begin cutting on the top of your head. Slowly and gently steer the clipper around the scalp, taking care on areas where there may be warts, moles, spots and broken skin, and keep away from the ears.
- Again, remember you must have a shorter hairstyle length to begin, as this item will not work on longer, layered hair.

FOR BEST RESULTS, USE IN A CIRCULAR MOTION

- The clipper can be moved in any direction to cut your hair. Only apply gentle pressure. Never force the clipper — if resistance is felt, lift clipper away from the head, empty hair from the clipper and resume clipping.
- If using on areas where there are folds of skin, ensure the skin is stretched taut prior to cutting hair in this area.
- If you experience any discomfort, stop using immediately.

- **NOTE:** Hair will collect in the area inside the blade ring. This may need to be emptied before all the hair has been cut. Switch the clipper OFF and remove any hair by simply tapping gently on the top of the clipper.
- If you require a grade 0 cut, the clipper can be used without a comb guide attached for an ultra-close, even cut.

CLEANING & MAINTENANCE OF CLIPPER

To maintain optimum performance, the appliance should be cleaned after each use:

- Remove the comb guide after use. Rinse the comb guide under running water and dry thoroughly before storage or use.
- Never place the clipper under running water.
- After each use, ensure hair is emptied from the blade area and use the cleaning brush to clean thoroughly.
- It is highly recommended to apply a small amount of oil (provided) to the blades before each use.
- Wipe the outside with a damp cloth and dry thoroughly before use or storage.

STORAGE

When not in use, allow clipper to cool and store in a safe, dry location and out of the reach of children. Never pull, twist or wrap the cord around the clipper.

BATTERY DISPOSAL

This appliance contains Nickel Metal Hydride batteries. To protect the environment, this appliance and its batteries must be disposed of safely. At the end of its life, please take this appliance to a recycling center where the internal rechargeable battery should be removed by a professional and recycled separately. For more information about the recycling of electrical and battery-operated appliances, please contact your local council office or your household waste disposal service. For specific enquiries regarding the replacement of batteries in this product, please contact our Conair Customer Service Center.

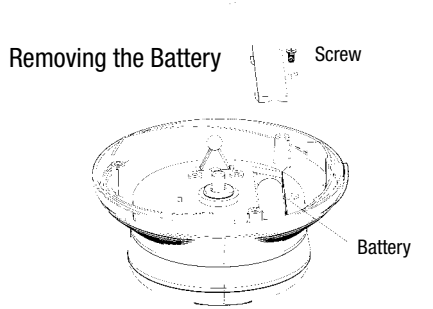
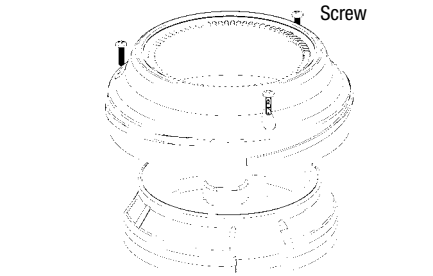

Model HC900 Series Cord/Cordless Clipper



- 1 Barber Comb
- 2 Scissors
- 3 Neck Brush
- 4 Oil
- 5 Storage Pouch
- 6 2 Adjustable Comb Guides
- 7 Barber Cape

ARGENTINA WARRANTY

Congratulations! You have purchased a guaranteed CONAIR product.

Warranty conditions:

1. The warranty is valid for 12 months from the date of purchase. To make it effective, you must submit the purchase invoice, which must be within the warranty period.
2. The warranty only applies to proven manufacturing defects. The product will be inspected and will be exchanged and/or repaired free of charge only if it presents an electrical or mechanical manufacturing defect within the warranty period.
3. The warranty does not apply:
 - 3.1. If the product has been opened, disassembled or repaired by unauthorized personnel.
 - 3.2. If the product has been used other than for domestic/household use, and/or for purposes for which it has not been designed.
 - 3.3. If the damages are not manufacturing defects but damages caused by: impact, spills or spill residues on parts, insects, or any other external factors, as demonstrated during inspection; as well as damages caused by misuse, contrary to what is stated in the instruction manual.
 - 3.4. If the damages or failures were caused by accidents, unforeseen or deliberate causes, electric shocks, voltage fluctuations and/or voltage 10% greater or lesser than the one indicated on the product's rating plate.
 - 3.5. If the damages or failures were caused by accessories and parts broken or damaged during improper use of the product.

WE RECOMMEND THAT YOU READ THE INSTRUCTION MANUAL.

IMPORTANT: KEEP YOUR PURCHASE RECEIPT. ONLY ARTICLES ACCOMPANIED BY THE INVOICE/RECEIPT FROM THE STORE WHERE THE ITEM WAS PURCHASED WILL BE ACCEPTED.

Customer Service: Conair
0810-888-2847 and 5300-5823
Hours of operation: 8 am to 8 pm

CHILE / PERU / AL CERTIFICATE OF WARRANTY

Congratulations You have purchased a guaranteed CONAIR product. Conair and its brands: Cuisinart, Waring and CONAIR, extend the following service warranty, which entitles you to enjoy all the advantages that our network of Authorized Technical Services provides. Terms and Conditions of the Certificate of Warranty:

1. The warranty is valid from the date of purchase. To make it effective, the customer must present a proof of purchase and the Certificate of Warranty.
- 2-. The warranty only applies to proven manufacturing defects. The product will be inspected and will be exchanged and/or repaired only if it presents any electrical or mechanical manufacturing defect.
- 3-. The warranty does not apply:
 - 3.1- If the product has been opened, disassembled or repaired by unauthorized personnel.
 - 3.2-. If the product has been used for purposes for which it has not been designed.
 - 3.3-. If the damages are not manufacturing defects, e.g. impact damage, spill damage, insect damage or any other damages found during inspection.
 - 3.4-. If the damages were caused by accidents, accidental or deliberate acts, or voltage 10% greater or lesser than the one indicated on the product's rating plate.
 - 3.5-. If the damages are due to the normal wear of parts and/or accessories during normal use.
 - 3.6-. If the damages were caused to accessories and parts during improper use of the product.

**We recommend that you read the instruction manual.

IMPORTANT! PLEASE KEEP THIS CERTIFICATE OF WARRANTY, STAMPED BY THE ESTABLISHMENT WHERE THE PRODUCT WAS PURCHASED. YOU WILL BE REQUIRED TO PRESENT IT FOR ANY CLAIM UNDER THIS WARRANTY.

MODELS #: HC900AL, HC900AR, HC900CL, HC900PE

SERIAL #: _____

DATE OF PURCHASE: _____

INVOICE #: _____

THE WARRANTY PERIOD IS INDICATED ON THE PRODUCT BOX

VENDOR'S NAME AND STAMP: _____

CLIENT'S SIGNATURE AND ID #

CORTADOR DE CABELLO
MARCA: CONAIRMAN

MODELO: HC900AL Latino-America
HC900AR Argentina
HC900CL Chile
HC900PE Perú

3.0V--- 1.5A 4.5W
HECHO EN CHINA

ADVERTENCIAS DE SEGURIDAD MANUAL
LEER MANUAL ANTES DE USAR

DATOS TÉCNICOS DE LA FUENTE DE ALIMENTACIÓN

MARCA: CONAIRMAN
MODELO: YLJXA-E030150
ADAPTADOR CA15
ENTRADA: 100-240V~ 50-60Hz
0.5A Max.
SALIDA: 3.0V--- 1.5A 4.5W
DESCRIPCION: Fuente de Alimentacion



www.tuv.com
ID 1419037674

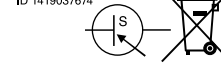

IP24 ta=40°C

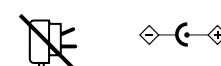

www.conairlatam.com
©2021 Conair Corporation
Origen: China

Argentina
Importa Distribuye y Garantiza Newsan S.A.
Roque Pérez 3650-C1430FBX
C.A.B.A. República Argentina

Chile
Importado por : VENTIS SPA
El Estero 5533, Condominio El Estero,
Penalolen, Santiago, Chile.
TEL: +(569)78088043/ +569 9
61855284/+56975374879
RUT : 76229287-4

Perú
Importado y Distribuido por: MACROTEL S.A.C.
Av. Arequipa 4130 Dpto. 205 Miraflores, Lima, Perú.
RUC : 20546288979

Colombia
Importado por: Continente S.A.S.
Calle 69 # Via 40-301,
Barranquilla, Atl, Colombia
Línea Servicio al Cliente: 018000415385
sac@continente.com.co

21P076120

IB-17063